



Nottingham, NG8

Guide Price £210,000

2 1 1

- SEMI DETACHED BUNGALOW
- TWO BEDROOMS
- SOUGHT AFTER LOCATION
- UPVC DOUBLE GLAZING
- GAS CENTRAL HEATING
- IN NEED OF UPGRADING
- CLOSE TO WOLLATON PARK
- IMMENSE POTENTIAL



Introducing this charming two-bedroom bungalow located in the desirable neighborhood of NG8. While this property boasts immense potential, it is in need of upgrading, making it an ideal opportunity for those looking to put their personal touch on a home.

Situated in NG8, this two bedroom bungalow benefits from a convenient location with excellent transport links, including nearby bus routes to Nottingham City Centre and easy access to major roadways. Local amenities, shops, and schools are within close proximity as is Wollaton Hall Deer Park, the QMC and Nottingham University Campus.

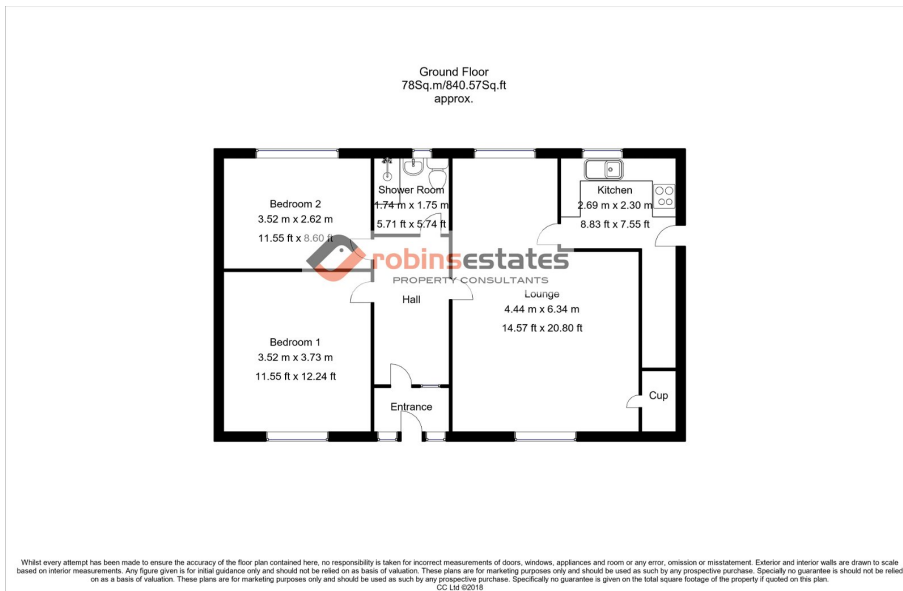

Give Erica or Angela a call on 0115 8240235
 Email us: enquiries@robinsstates.com
 5 Derby Terrace, Derby Road, Nottingham, NG7 1ND

